

## SURE PROOF

### Membrane & Primer

SureProof is a high performance, cold applied, flexible, waterproof membrane incorporating a cross-laminated HDPE carrier film with a strong adhesive polymer modified bitumen compound.



#### SureProof Schematic

- 1 Fillet Seal
- 2 SurePrime MT
- 3 SureProof
- 4 Protection Board

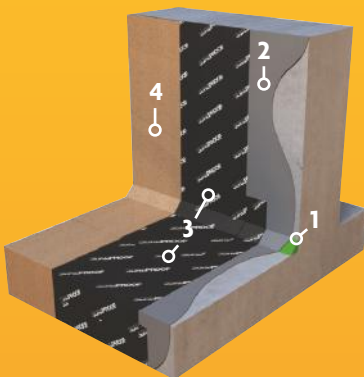

The adhesive surface is protected by a disposable paper interleaving wider than the membrane for easy release during application. To ensure correct sealing at overlaps there is a double-sided adhesive strip along the edges covered by a separate interleaving strip.

SureProof should be laid in accordance with the provisions of BS 8102:2009. Where SureProof is being used as a floor DPM there should be continuity with the wall DPC's and other DPM's used in the structure. If methane presence is suspected, a comprehensive site survey needs to be carried out and Wykamol's technical department contacted to advise on suitability of SureProof.

## ADVANTAGES

- Resistant to ground water, soluble sulphates and chlorides.
- Suitable for waterproofing basements grades 2 & 3 as defined in BS 8102:2009, 'protection Of Structures Against Water From The Ground'.
- Cross-laminated HDPE film for protection against damage.
- Dimensionally stable.
- Tough and flexible, ideal for detailing around corners.
- Self-adhesive layer system makes installation easy, quick and reliable.
- BBA Certified.

## TYPICAL USES

- Isolate and protect external structure from surrounding soil.
- Helps relieve hydrostatic pressure from the face of the structure.
- Ideal for retaining walls, podium decks, external tanking and green roof applications.

# TECHNICAL DATASHEET

## SUBSTRATE PREPARATION

All surfaces must be clean, dry and free from contamination, ice and frost. Masonry surfaces must be flush pointed and all concrete surfaces must be a wood float or shutter finish and free from cavities or projections.

## PRIMING

All surfaces shall be primed with SurePrime MT. Follow application instructions on SurePrime MT technical datasheet, ensure complete coverage and allow to dry.

Very porous surfaces may require more than one coat of primer and ensure the area primed, SureProof can be applied in the same day. Application temperature range with SurePrime MT : 5° C to 35° C.

## ANGLE AND CORNER DETAILS

Where possible, a 25mm chamfer should be provided to all external angles prior to application of the reinforcing strip.

For internal and external corners use Wykamol Universal mortar as a fillet seal at all wall to floor junctions. Use of preformed fillets which are adhered correctly can also be used as well as a suitable concrete fillet.

All internal and external angles should be reinforced with SureProof reinforcing tape or alternatively a 300 mm wide strip of SureProof.

## HORIZONTAL

Completely unroll SureProof membrane and place against chalk line. Roll one half up to the mid-point, carefully cut the release paper, without damaging SureProof membrane and progressively remove from the mid-point out to the end of the roll.

Repeat the process on the other half of the roll. Adequately brush SureProof onto the surface ensuring good bonding.

The next roll is aligned against the previously applied membrane allowing for the 50 mm minimum (or as specified) edge laps and 150 mm end laps and apply as above.

Ensure the edge and end laps are rolled to ensure complete continuity and bond between both layers.

## VERTICAL

Cut SureProof to the correct length allowing 150 mm for the end laps. Correctly position by peeling back the release paper and applying the self-adhesive face to the primed surface.

Ensure to start at the top of the wall and work down, progressively removing the release paper in stages. SureProof should be applied to ensure that all end laps are weathered.

**NOTE.** When hanging the membrane vertically, the use of temporary batten support at the top of the wall application is recommended, and or return the membrane over the top of the concrete or block wall and fix a temporary batten at this point. The temp battens can be removed as the installation progresses.

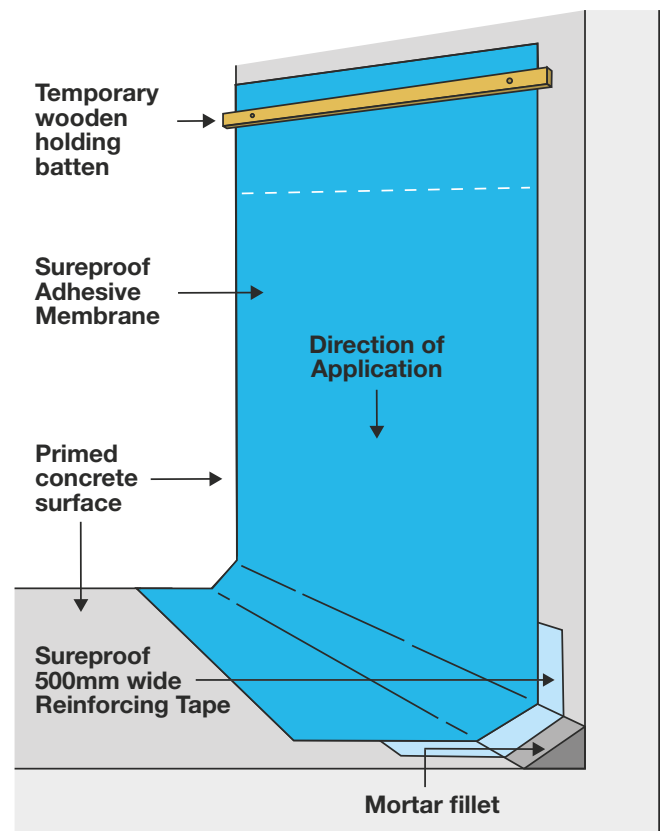

## PROTECTION

SureProof membrane should be protected from physical damage and weathering as soon as possible after application using SureProof protection board.

# SUREPROOF MEMBRANE & PRIMER

## PENETRATIONS

Pay special attention to detail when penetrating SureProof for reasons such as creating pipe entries etc.

## PACKAGING

### SUREPROOF

Roll size	1.05 m x 19.05 m
Roll area	20m <sup>2</sup>
End laps	150mm minimum
Edge laps	50mm minimum
Weight	33Kg

## ANCILLARY PRODUCTS

SurePrime MT, SureProof reinforcing tape and SureProof protection board.

### SUREPRIME MT

Coverage	6 to 8 m <sup>2</sup> /litre
Pack size	5 Litre & 25 litre Drums
Minimum installation temperature:	≥ + 5°C
Drying time @ 20°C	1 to 2 hours



Property & Test method	Units	Result
Water tightness to liquid water (EN 1928, Method A, 60 KPa)	-	Pass
Resistance to Static Load (EN 12730)	Kg	≥ 20
Tensile properties, Maximum Tensile Stress CD (EN 12311-2)	N/mm	2 ≥ 2.5
Tensile properties, Maximum Tensile Stress MD (EN 12311-2)	N/mm	2 ≥ 2.5
Tensile properties, Elongation at break MD (EN 12311-2)	%	≥ 130
Tensile properties, Elongation at break CD (EN 12311-2)	%	≥ 130
Durability of Water tightness against ageing (EN 1847, Method A, 60 KPa)	-	Pass
Durability of Water tightness against chemicals (EN 1847, Method A, 60 KPa)	-	Pass
Resistance to Impact (EN 12691)	mm	≥ 500
Resistance to tear (Nail Shank) CD (EN 12310-1)	N	≥ 100
Resistance to tear (Nail Shank) MD (EN 12310-1)	N	≥ 100
Reaction to Fire (EN 13501)	Euro Class	Class F
Joint strength (EN 12317-2)	N	≥ 30
Water Vapour Transmission (Density Flow rate) (EN 1931)	g/(day/m <sup>2</sup> )	0.09
Water Vapour Transmission (Resistance factor, μ) (EN 1931)	μ	220000

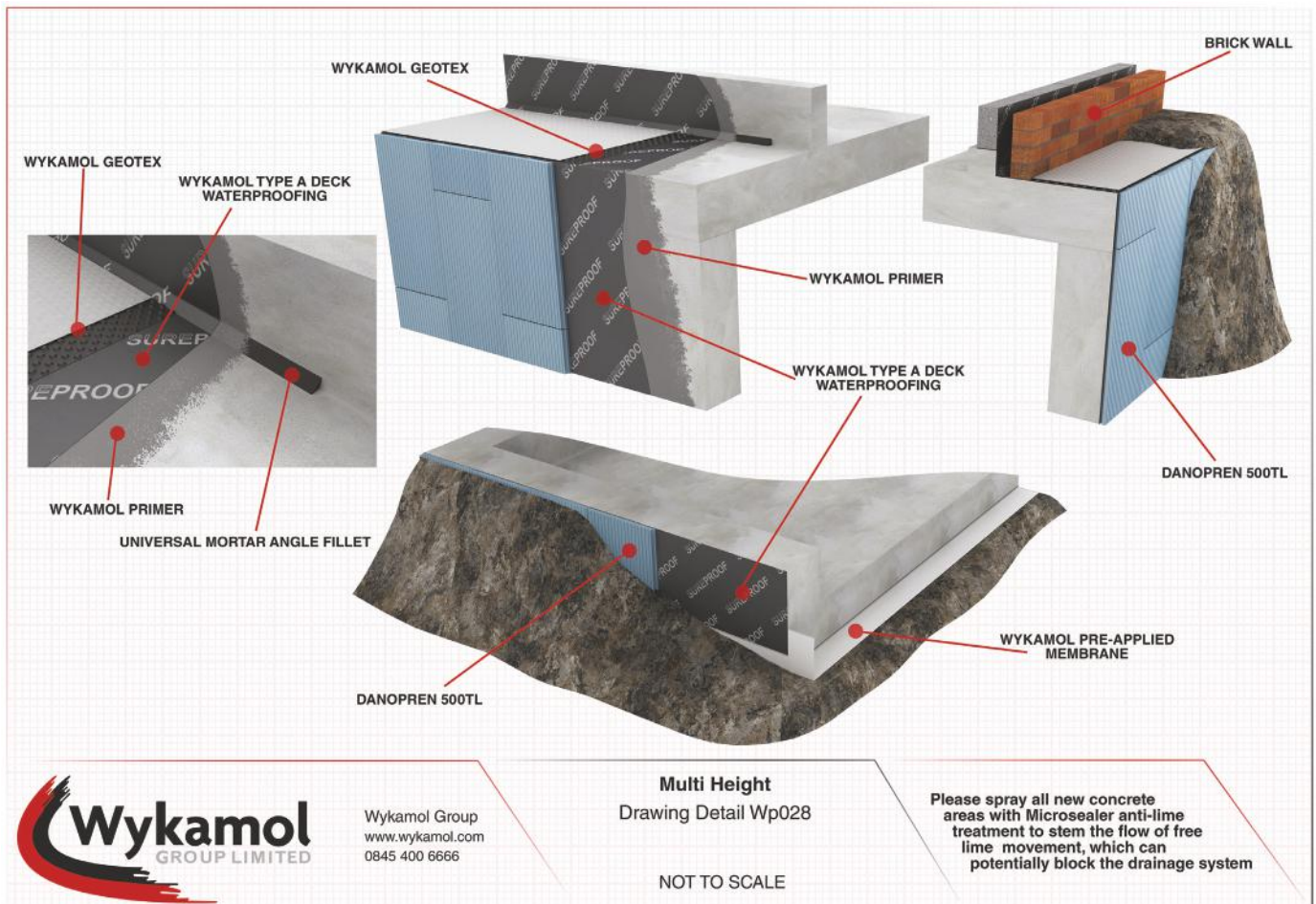

Wykamol Group  
www.wykamol.com  
0845 400 6666

## STORAGE & SHELF LIFE

SureProof has a 12 month shelf life when stored in an upright position and at temperature between 5° C and 40° C.

SurePrime MT has a 12 month shelf life when stored un-opened and at temperatures between 5° C and 30° C.

## HEALTH AND SAFETY

Please consult material safety data sheets.

Flash point for SurePrime MT is > 39° C.

\*Please note : Each roll of SureProof weights approx. 35 KG and should be lifted by a minimum of 2 operatives.



Unit 3, Boran Court, Network 65 Business Park, Hapton, Burnley  
Lancashire BB11 5TH

t: +44 (0)845 4006666 f: +44 (0)845 4003333

www.wykamol.com e: info@wykamol.com



The information in this technical datasheet is given in good faith and was correct at the time of publication, but does not purport to be all inclusive. We reserve the right to update this information at any time without prior notice. All data is obtained through extensive testing in stringent laboratory conditions, however as we have no control over site conditions or work executed we accept no liability for incidental and/or consequential property damage arising out of the use of this product. The Wykamol Group's standard terms and conditions of sale apply.